

RoHS Compliant

ANGLE	± 5°	REV	LOCAS	DESCRIPTION	DESIGN	DATE	设计师
X.XXX	± 0.05	01			DRAWN	DATE	内修
X.XX	± 0.15	02			CHECKED	DATE	吴汉学
X.X	± 0.25	03			AUDITED	DATE	曾志松
X	± 0.50	04			APPROVED	DATE	eric

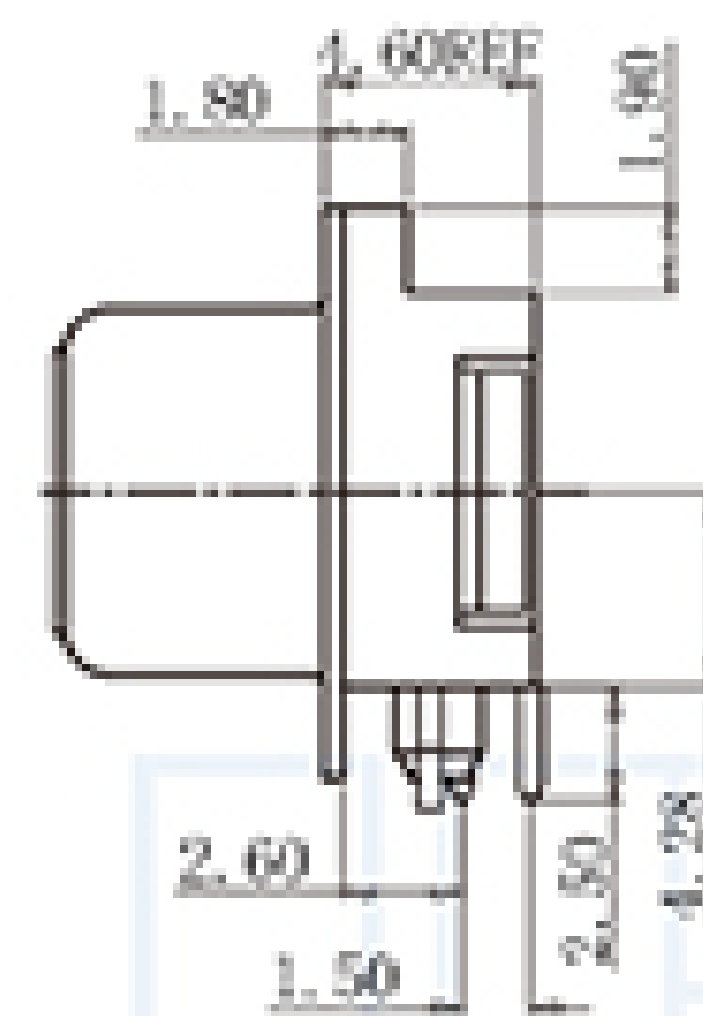
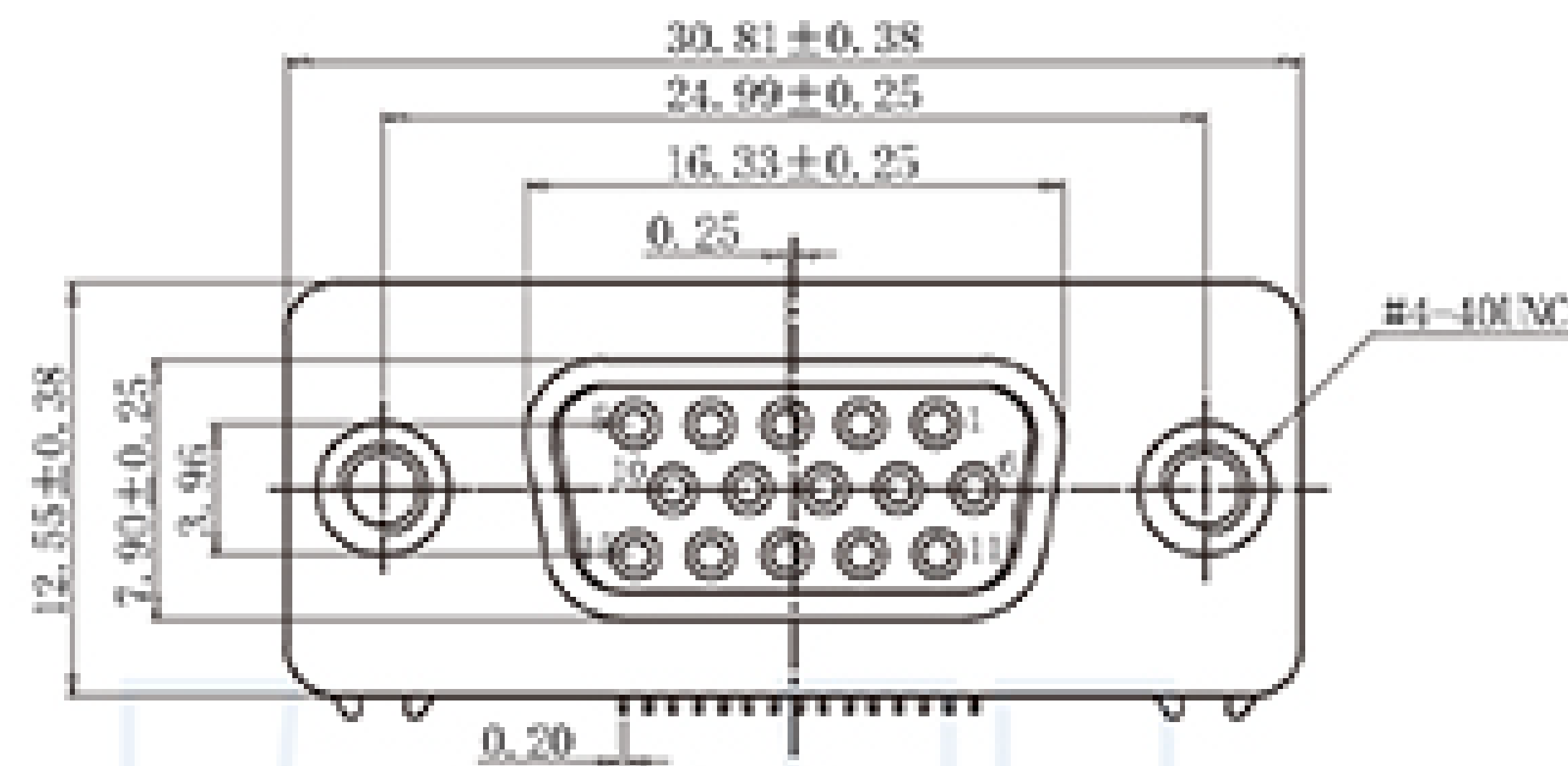

SPECIFICATIONS

ELECTRICAL CHARACTERISTICS:

Contact Current Rating:3 Amperes.
 Dielectric Withstanding Voltage: AC 1000/60sec.r.m.s.
 Insulation Resistance:5000 Medohms Minimum.at DC 500V.
 Contact Resistance:25 Milliohms Maximum.
 Operating Temperature:-55°C to+105°C.

MECHANICAL CHARACTERISTICS:

Contact Insertion Force:341 g.Maximum.
 Contact Separation Force:21 g.Minimum.

MATERIALS:

Contacts:Brass.
 Insulator: PBT UL 94V-0 Rated.
 Shell: Cold Roller Steel.

FINISHES:

Contact:Gold Flash.
 Shell:Nickel Plated.

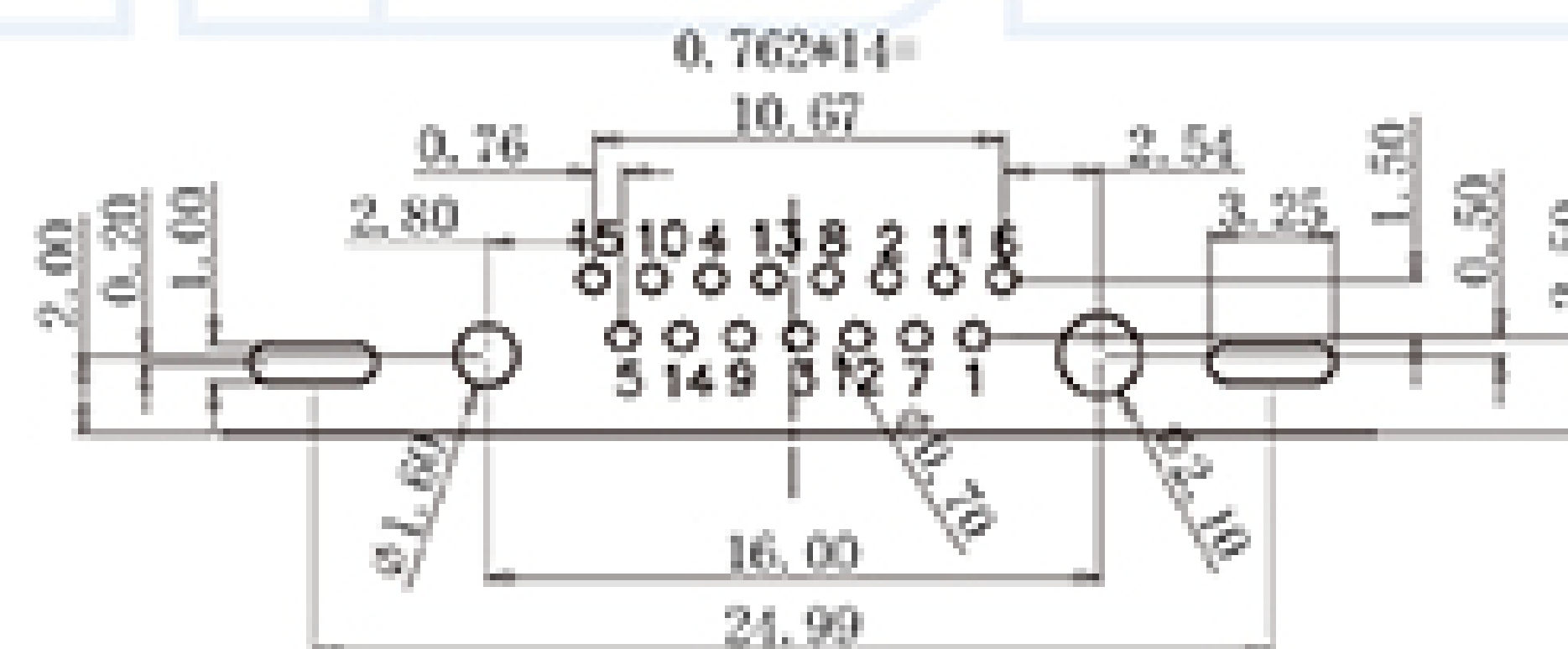
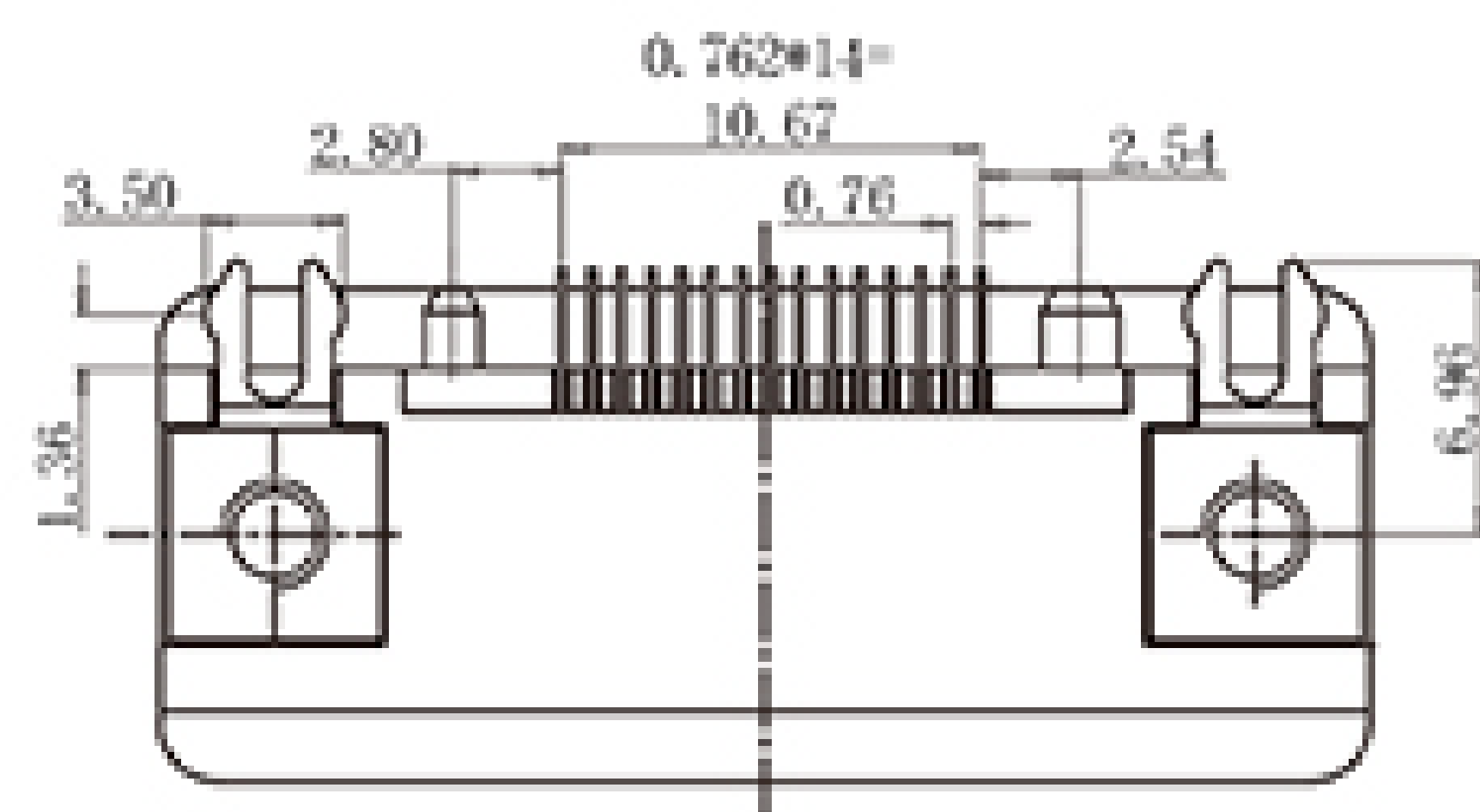
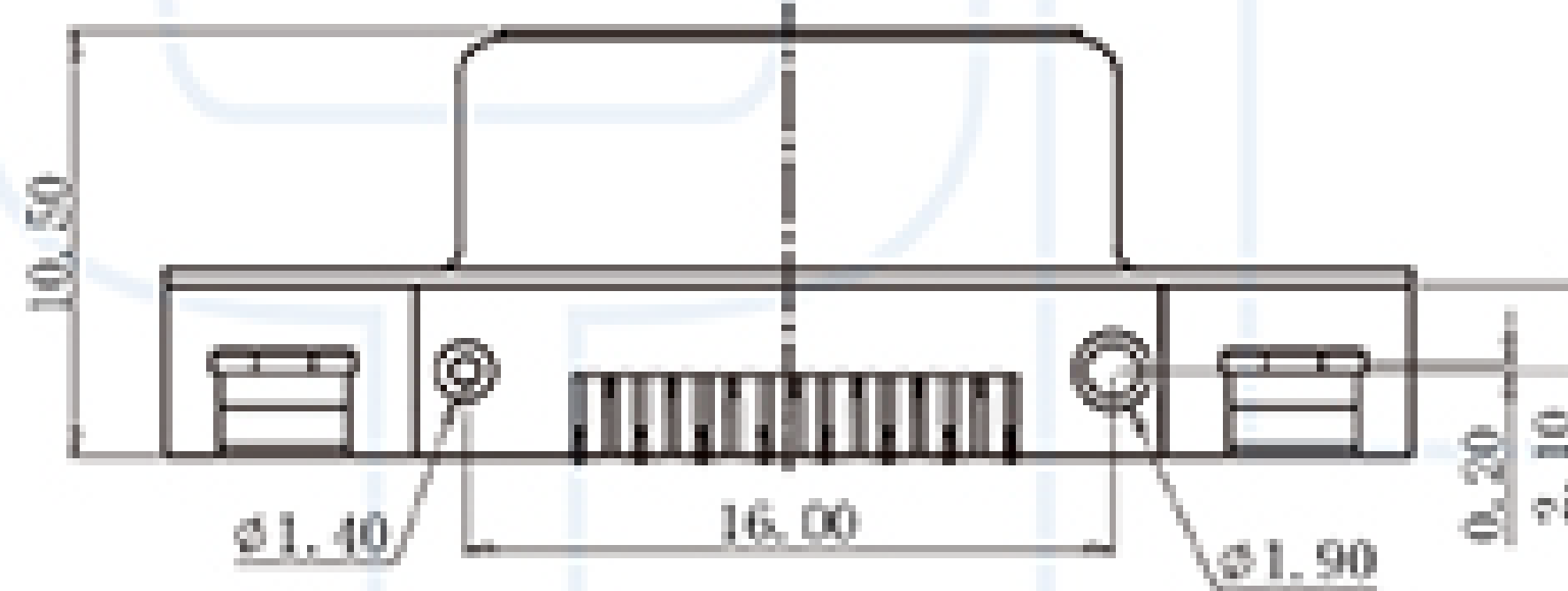

YLIES 东莞市瑞翔精密连接器有限公司
 DONG GUAN YLIES PRECISE CONNECTOR CO.,LTD

Tel:0769-85381995 / Fax:0769-85493987 / Email: ylies@ylies-china.com / Web:www.ylies-china.com

TITLE SLIM 15P母头前七后八沉板式 铆合蓝胶,

DATE 2020-04-18

PROJECTON REV A UNIT mm SCALE 1:1 PAGE 1/1

PART NO:

DRAWING NO:

1 2 3 4 5 6 7 8 9