

1 2 3 4 5 6 7 8 9

|       |        |     |       |             |          |      |      |
|-------|--------|-----|-------|-------------|----------|------|------|
| ANGLE | ± 5°   | REV | LOCAS | DESCRIPTION | DESIGN   | DATE | 卫国峰  |
| X.XXX | ± 0.05 | 01  |       |             | DRAWN    | DATE | 尚伟   |
| X.XX  | ± 0.15 | 02  |       |             | CHECKED  | DATE | 吴汉学  |
| X.X   | ± 0.25 | 03  |       |             | AUDITED  | DATE | 龚劲松  |
| X     | ± 0.50 | 04  |       |             | APPROVED | DATE | eric |

**Specifications/备注 (Remark)**

Insulator:Black glass filled polyester  
 PPS-GF30-FR  
 Flammability:UL94V-0  
 Sleeve:Brass CuZn 36Pb3(36000)  
 Contact clip(4 finger):Beryllium copper(C17200)  
 Mating pin:Ø0.40 to 0.56mm  
 Forces:(polished steel gauge Ø0.43mm)  
 Insertion:2.0 N typ  
 Withdrawal:1.0 N typ  
 Mechanical life:min 500 cycles  
 Rated current:3.0Amp  
 Contact resistance:Max 10mΩ  
 Dielectric resistance:Min 1000V RMS

Contact length L:  
 6mm, 7mm, 8mm, 9mm, 10mm,  
 11mm, 12mm, 13mm, 15mm,  
 18mm, 22mm, 33mm

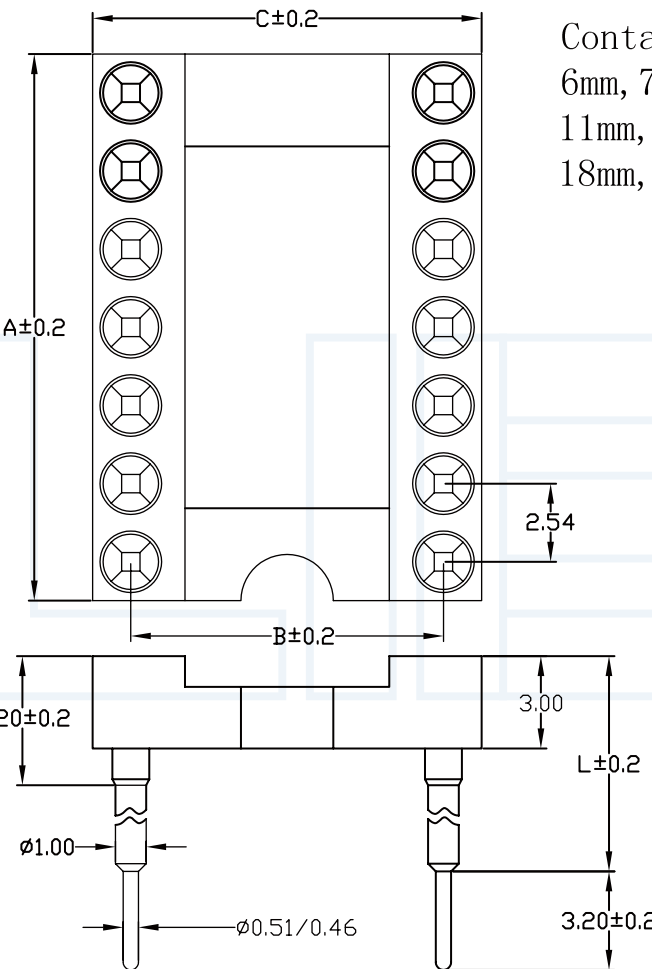

**ORDERING INFORMATION**  
**R2630-2 XX X XG S XXX C 1**

HEIGHT OF HOUSING: 30:3.0mm  
 NO. OF PINS PER ROW: 06-64P  
 NO. OF ARRAY PITCH:  
 0:NO PITCH  
 4:7.62mm  
 5:10.16mm  
 6:15.24mm  
 7:22.86mm  
 CONTACT PLATING:  
 A=1U"  
 B=2U"  
 ... ..  
 E=15U"  
 F=30U"  
 S=ORDINARY TIN PLATED  
 H=HALF GOLD PLATED TIN  
 LENGTH OF TERMINAL:  
 092:9.20mm  
 102:10.2mm  
 112:11.2mm  
 122:12.2mm

| See page 33 | No. of Positions | A    | B     | C    |
|-------------|------------------|------|-------|------|
| fig. 1      | 6                | 7.6  | 7.62  | 10.1 |
| fig. 2      | 8                | 10.1 | 7.62  | 10.1 |
| fig. 3      | 10               | 12.6 | 7.62  | 10.1 |
| fig. 4      | 12               | 15.2 | 7.62  | 10.1 |
| fig. 5      | 14               | 17.7 | 7.62  | 10.1 |
| fig. 6      | 16               | 20.3 | 7.62  | 10.1 |
| fig. 7      | 18               | 22.8 | 7.62  | 10.1 |
| fig. 8      | 20               | 25.3 | 7.62  | 10.1 |
| fig. 9      | 22               | 27.8 | 7.62  | 10.1 |
| fig. 10     | 24               | 30.4 | 7.62  | 10.1 |
| fig. 11     | 28               | 35.5 | 7.62  | 10.1 |
| fig. 12     | 20               | 25.4 | 10.16 | 12.6 |
| fig. 13     | 22               | 27.8 | 10.16 | 12.6 |
| fig. 14     | 24               | 30.4 | 10.16 | 12.6 |
| fig. 15     | 28               | 35.5 | 10.16 | 12.6 |
| fig. 16     | 32               | 40.6 | 10.16 | 12.6 |
| fig. 17     | 24               | 30.5 | 15.24 | 17.7 |
| fig. 18     | 28               | 35.5 | 15.24 | 17.7 |
| fig. 19     | 32               | 40.6 | 15.24 | 17.7 |
| fig. 20     | 36               | 45.7 | 15.24 | 17.7 |
| fig. 21     | 40               | 50.8 | 15.24 | 17.7 |
| fig. 22     | 42               | 53.3 | 15.24 | 17.7 |
| fig. 23     | 48               | 60.9 | 15.24 | 17.7 |
| fig. 24     | 50               | 63.5 | 15.24 | 17.7 |
| fig. 25     | 52               | 66.0 | 15.24 | 17.7 |
| fig. 26     | 50               | 63.5 | 22.86 | 25.3 |
| fig. 27     | 52               | 66.0 | 22.86 | 25.3 |
| fig. 28     | 64               | 82.1 | 22.86 | 25.3 |

**YLIES** 东莞市瑞翔精密连接器有限公司  
 DONG GUAN YLIES PRECISE CONNECTOR CO.,LTD

TITLE: 287-2.54mm IC 圆孔排母 180度 DATE: 2018-02-18

Tel:0769-85381995 / Fax:0769-85493987 / Email: ylies@ylies.cn / Web:www.ylies.cn

PROJECTON REV A UNIT mm SCALE 1:1 PAGE 1/1 PART NO: R2630-2XXXXGSXXXC1 DRAWING NO:

1 2 3 4 5 6 7 8 9